

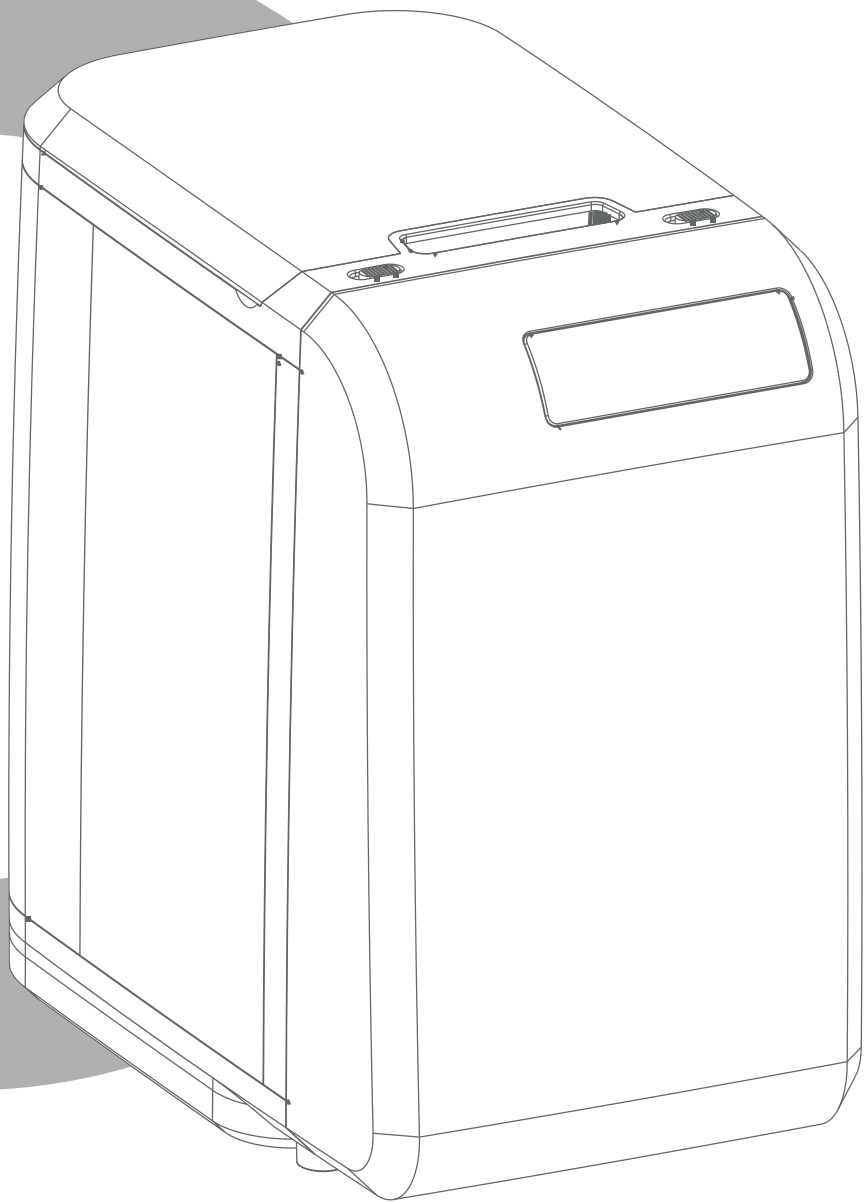

G500

Installation & Operating Manual

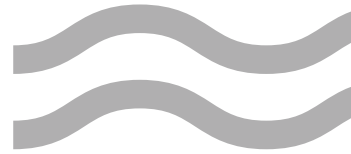

Compact Reverse Osmosis System

Where Water Gets Better

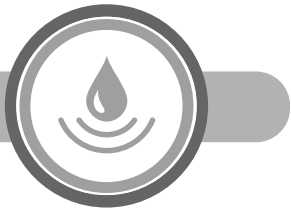

INTRODUCTION AND WARNINGS

G500 Compact Reverse Osmosis System

INTRODUCTION

Congratulations on your purchase of the G500™ Direct Flow Reverse Osmosis System.

The G500 Direct Flow Reverse Osmosis System is designed with advanced filtration technology, and utilizes a 5-stage filtration process to purify and deliver fresh tasting water. This system is designed exclusively for municipal water systems, and will remove volatile organic chemicals, chlorine, odor, sediment, suspended impurities, metals and other harmful contaminants from your water.

This instruction manual illustrates the G500 Direct Flow Reverse Osmosis System installation and operation. Please read the contents of this manual before installation.

The system should be installed by a qualified professional installer or licensed plumber. Installation must be in accordance with local and state plumbing codes.

! PRECAUTIONS BEFORE INSTALLATION

- **WARNING:** Do not use with water that is microbiologically unsafe or of unknown quality without adequate disinfection before or after the system.
- **WARNING:** The system may at no point be exposed to pressures above the rated pressure as this may cause system damage!
- **WARNING:** A qualified installer shall install protective devices if the system pressure may at any time exceed the rated maximum pressure due to pressure surges or water hammer, or other excessive pressure events to ensure that the maximum operating pressure of the system will not be exceeded!
- **CAUTION:** Water pressure must not exceed 4 bar | 60 psi. Minimum water pressure should not be lower than 1.4 bar | 20 psi.
- **CAUTION:** Protect system against freezing. Freezing can cause system damage and result in water leakage!
- **CAUTION:** Install the system in a sheltered or covered location and protect it from excessive heat!
- **CAUTION:** Do not install where the system will be exposed to direct sunlight!
- **CAUTION:** The system is intended for use with tap water, and should not be installed for use with other water sources, such as mountain spring water or groundwater.
- **CAUTION:** System must be installed on the cold-water piping line. Do not install on hot water piping. Inlet water temperature should not exceed 100°F | 38°C.
- **CAUTION:** Avoid ambient temperatures over 100°F | 38°C
- **CAUTION:** System contains replaceable sediment and activated carbon filters, as well as a replaceable reverse osmosis membrane which is critical for the effective reduction of TDS (Total Dissolved Solids). Water purified by this system should be tested periodically to confirm the system is operating properly.
- **CAUTION:** Filters must be installed according to labeling and with the designated inlet water flow direction.
- **CAUTION:** Pay attention to safety when drilling close to the wires and plumbing parts of the installation.

⚠ OTHER IMPORTANT INFORMATION

- Please note that the lifetime of the filters as well as their replacement interval strongly depends on the inlet water quality, the amount of water consumed, the sediment and chlorine content etc.
- System should be isolated from water supply and disconnected from power if not used for more than 1 week. If not used for a period of 1 month or more RO water storage tank should be emptied.

REPLACEMENT FILTERS AND PARTS

- Filters are consumables and are not covered by the warranty.
- Only use GWS approved replacement filters. Product warranty is void if non-GWS approved replacement filters are used.
- Only use GWS approved spare parts. In the case of any failure of the pump, electric adapter or any other replaceable part of the system, the replacement product must be approved by Global Water Solutions or an authorized GWS distributor. Product warranty is void if non-GWS approved spare parts are used.

SPECIFICATIONS

Product Series Name	G500™
Dimensions	44*26*44cm / 16.5*10.2*17.3 inch
Weight	19 kg / 41.9 lb
Maximum Tube Size	3/8"
Operating Pressure	1.4 - 4 bar 20 - 60 psi
Max. Pump Pressure	8.6 bar 125 psi
Power Input	110V 60Hz / 230V 50Hz / 60Hz
Power Consumption	36V DC / 2A
Operating Temperature	5°C - 38°C / 41°F - 100°F
Maximum TDS	2,000 ppm
Maximum Hardness	17 grains / gallon / 291 ppm
Maximum Iron	0.3 ppm
Maximum Manganese	0.05 ppm
Maximum Turbidity	2 NTU
Chlorine	0.2~1.0 ppm
pH	6.0~8.5



INSTALLATION & DIAGRAM

G500 Compact Reverse Osmosis System

COMPONENTS

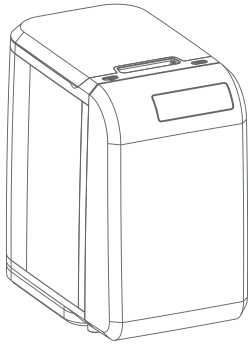

G500 COMPACT
RO SYSTEM

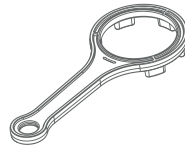

WRENCH

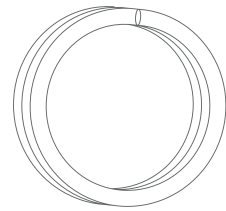

BLUE, WHITE &
BLACK TUBES

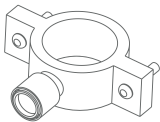

WASTEWATER CLIP

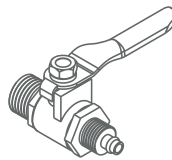

BRASS BALL VALVE

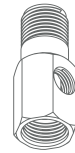

WATER ADAPTOR

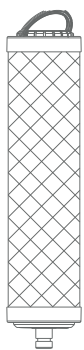

CARBON FILTER

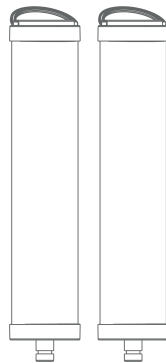

PP FILTER



REVERSE OSMOSIS
MEMBRANE

INSTALLATION INSTRUCTIONS

1. Place the G500 system in the cabinet. (refer to Fig. 1)
2. Connect the tube to the back of the G500's water outlet quick connect fitting. (refer to Fig. 1)

White tube: Filtered water outlet

Blue tube: Water inlet

Black tube: Wastewater

Fig. 1

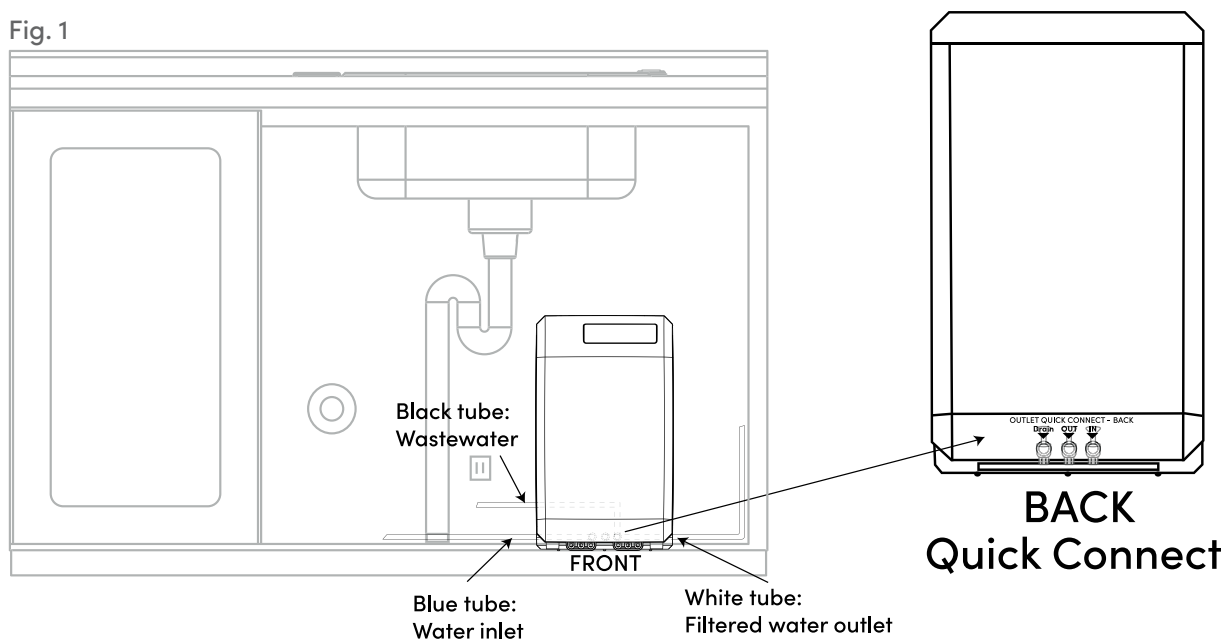

3. Install the faucet. (refer to Fig. 2.1)

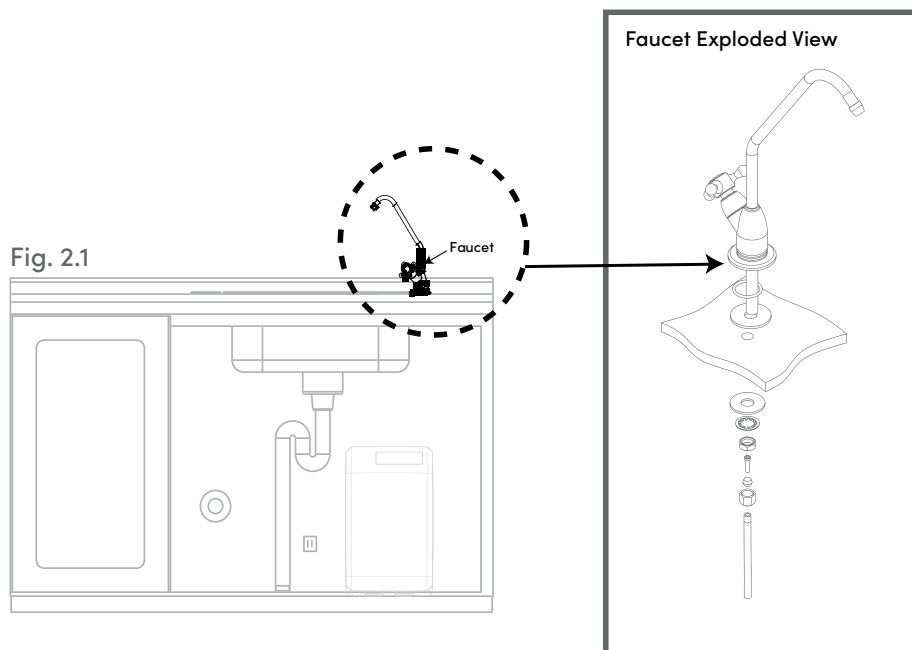



INSTALLATION MANUAL

G500 Compact Reverse Osmosis System

INSTALLATION INSTRUCTIONS

4. Connect the other end of white tube to the faucet. (refer to Fig. 2.2)

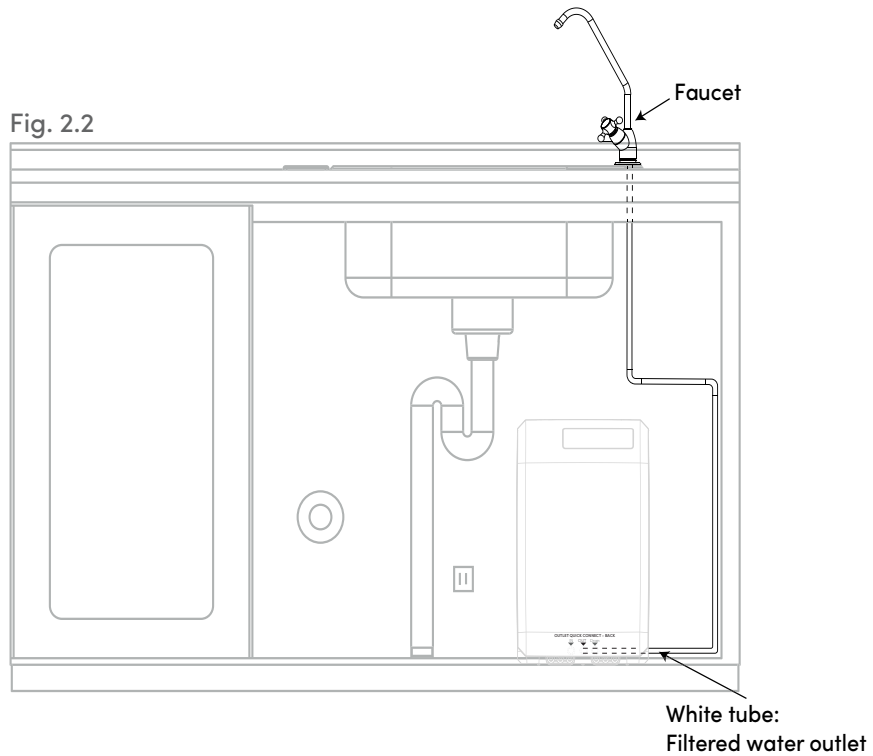

5. Connect water source to the water adapter and brass ball valve with blue tube. (refer to Fig. 3.1)

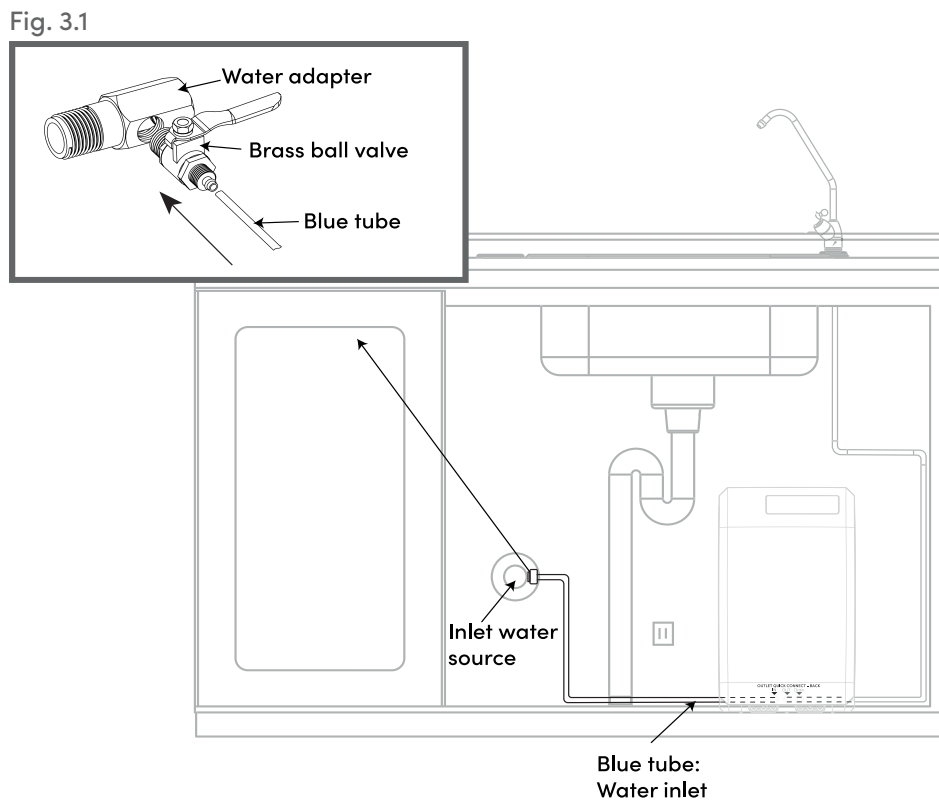

Compact Reverse Osmosis System

6. Connect the other end of the blue tube to the bottom back of G500's water inlet quick connect fitting. (refer to Fig. 3.2)

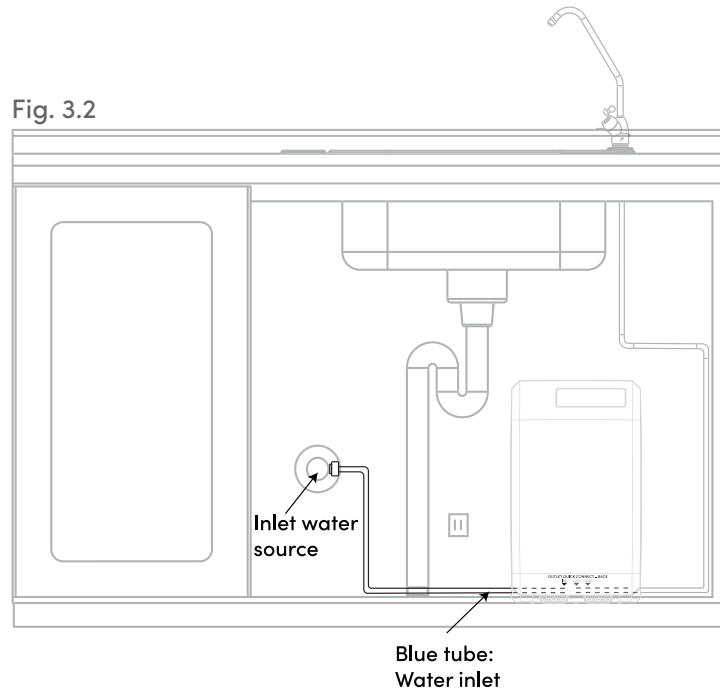

7. Connect the other end of the black tube to drainpipe using the wastewater clip. (refer to Fig. 4)

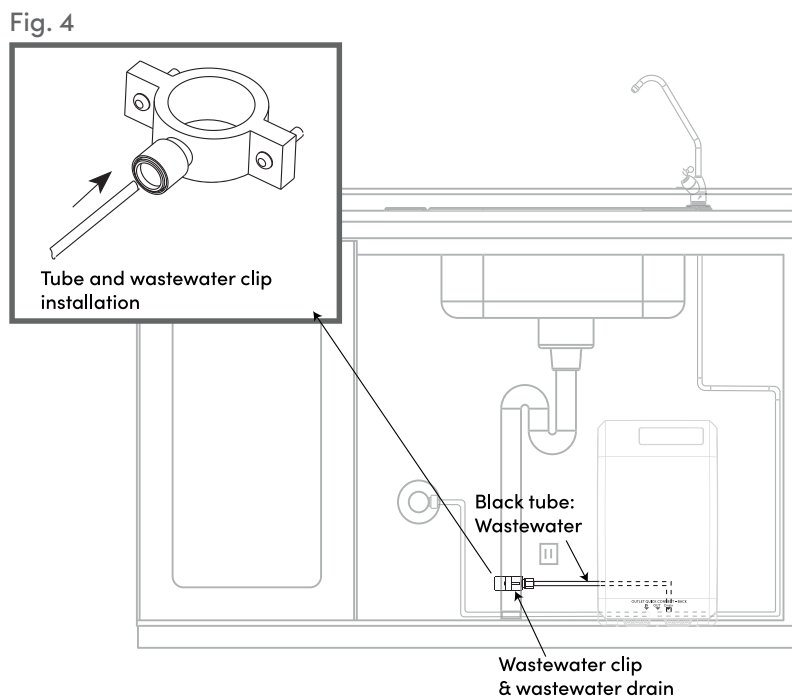



INSTALLATION MANUAL

G500 Compact Reverse Osmosis System

INSTALLATION INSTRUCTIONS

8. Plug in power cord and begin initial water purification run - Do not drink the filtered water in the start-up run. (refer to Fig. 5)

- a. Make sure that "Power On" light is on.
- b. Open faucet and wait for water to come out (this can take up to 15 seconds).
- c. Leave the faucet on, turn off power by unplugging the power cord (repeat this step three times).

When connecting the power cord again on the fourth time, "Auto Flush" light will blink, indicating the auto flush is operating. Auto Flush will last about 2 minutes.

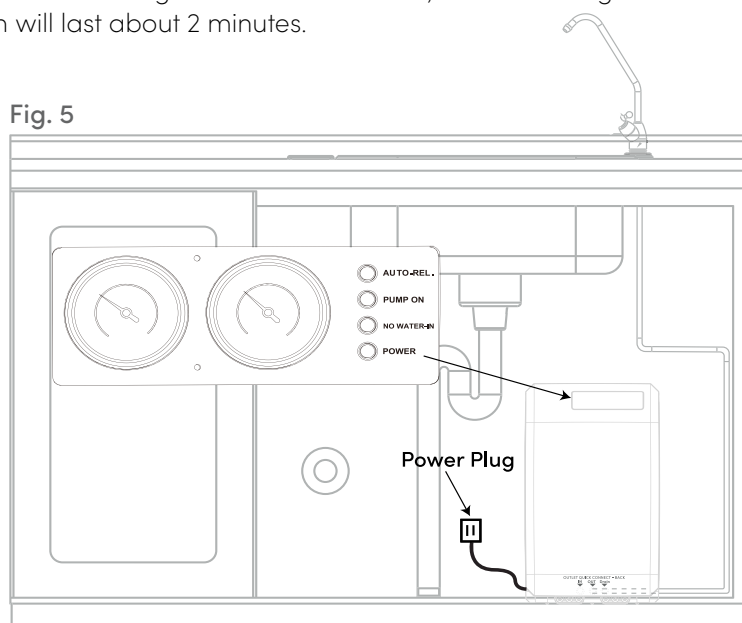

9. Please refer to Fig. 6 for installed G500's illustration. (refer to Fig. 6)

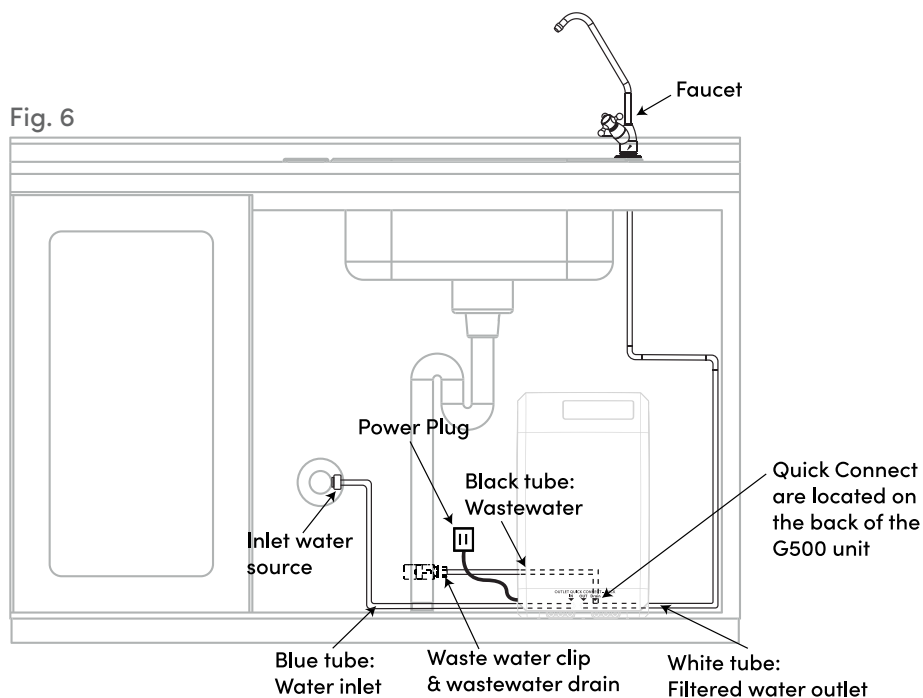

FILTER REPLACEMENT PROCEDURE

1. When replacing the filters, first release the water and air inside of the system by closing the water inlet. Open the faucet and drain out the water inside of the G500 system before opening the housing cover.

Important: For first installation, turn off the water inlet switch or water source. (refer to Fig. 1)

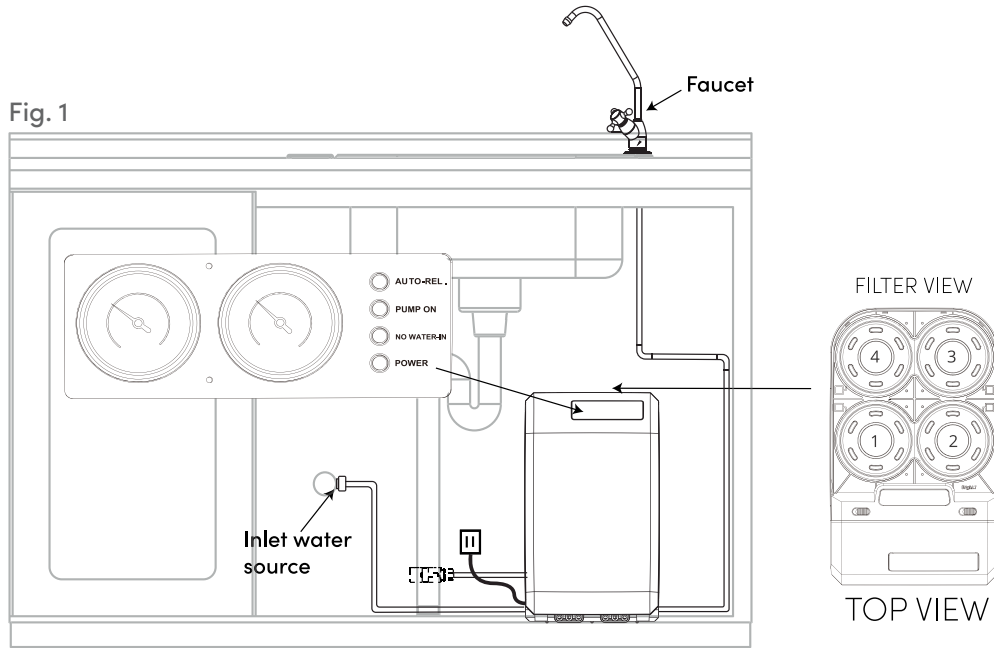

G500 SYSTEM LIGHT INDICATION

AUTO-REL.: A blinking light indicates that the system is performing auto flush.

A. At initial power up, the system will auto flush for 2 minutes.

B. Auto flush will perform 5 minutes after each time the system generates filtered water. Subsequent auto flush will last about 15 seconds. After continuous use of G500 for over 30 minutes, G500 will auto flush for a duration of 30 seconds.

PUMP ON: A blinking light indicates the system detects incoming water and the pump is turned on.

NO WATER-IN: A blinking light indicates water inlet is not detected or the incoming water's pressure is too low.

POWER: An indicator for power on. If the light is not turned on, please check if the power cord is plugged in.

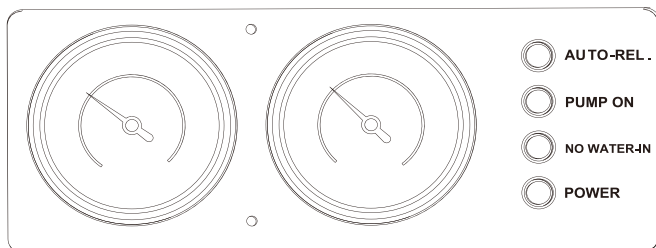

LEFT GAUGE

RIGHT GAUGE

Left gauge indicates water inlet pressure

Right gauge indicates water pump pressure



INSTALLATION MANUAL

G500 Compact Reverse Osmosis System

FILTER REPLACEMENT PROCEDURE

2. Open the top system lid and take out the filter cover using the wrench. (refer to Fig. 2)

Fig. 2
FILTER VIEW

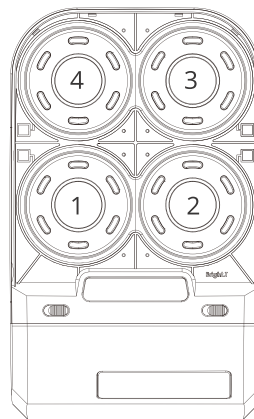

TOP VIEW

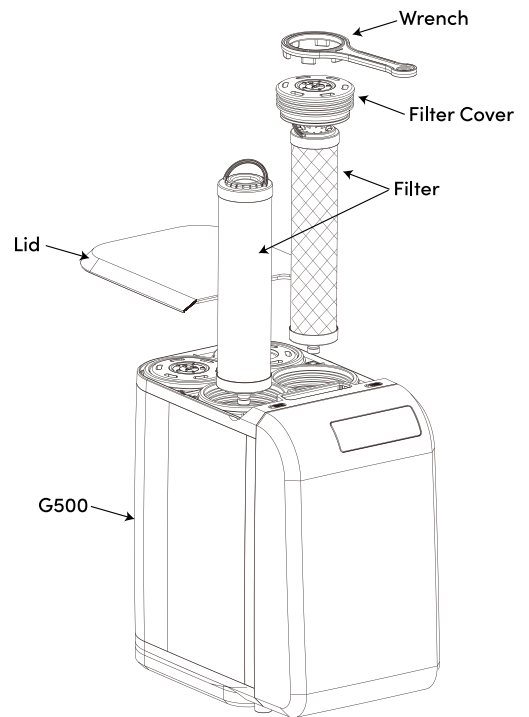

3. Filter should be placed according to the following instructions: (refer to Fig. 3)

- a. **Filter compartment #1:** PP filter (white filter top cap)
- b. **Filter compartment #2:** Carbon filter
- c. **Filter compartment #3:** PP filter (white filter top cap)
- d. **Filter compartment #4:** RO filter

Fig. 3
FILTER VIEW

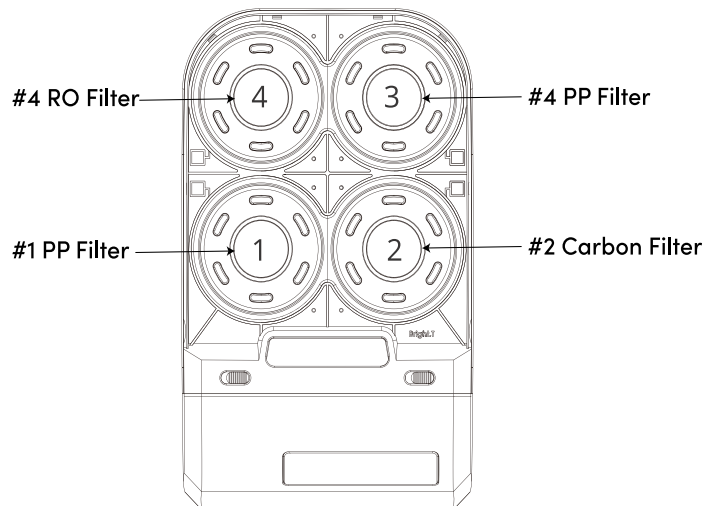

TOP VIEW

Compact Reverse Osmosis System

4. Filters should be pushed firmly into the respective filter compartments. (refer to Fig. 4)

Caution: Filter pull-ring should face up, and the filter O-ring should face downwards into the filter compartment

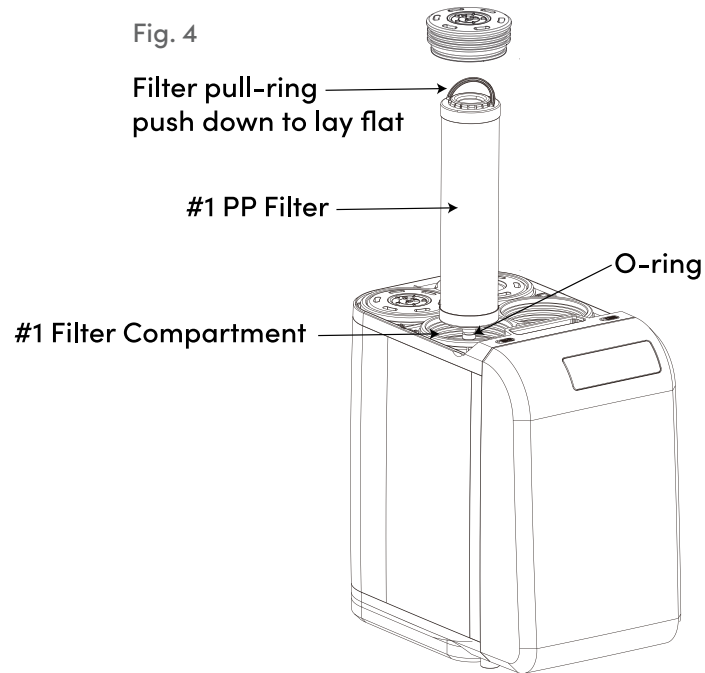

5. After installation or replacement of filter, use the wrench to close and tighten the filter housing cover. (refer to Fig. 5)

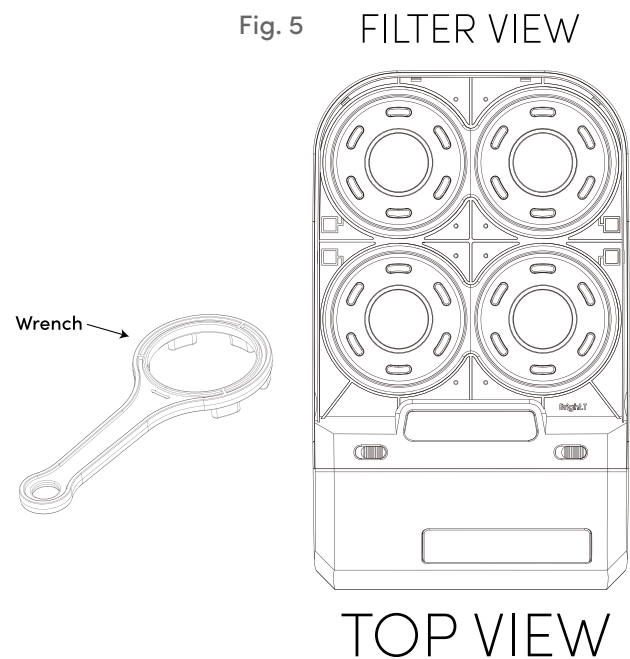



INSTALLATION MANUAL

G500 Compact Reverse Osmosis System

FILTER REPLACEMENT PROCEDURE

6. The system includes five filter cartridges; the fifth cartridge (post filter T33 carbon filter) has been installed in the front housing compartment. (refer to Fig. 6)

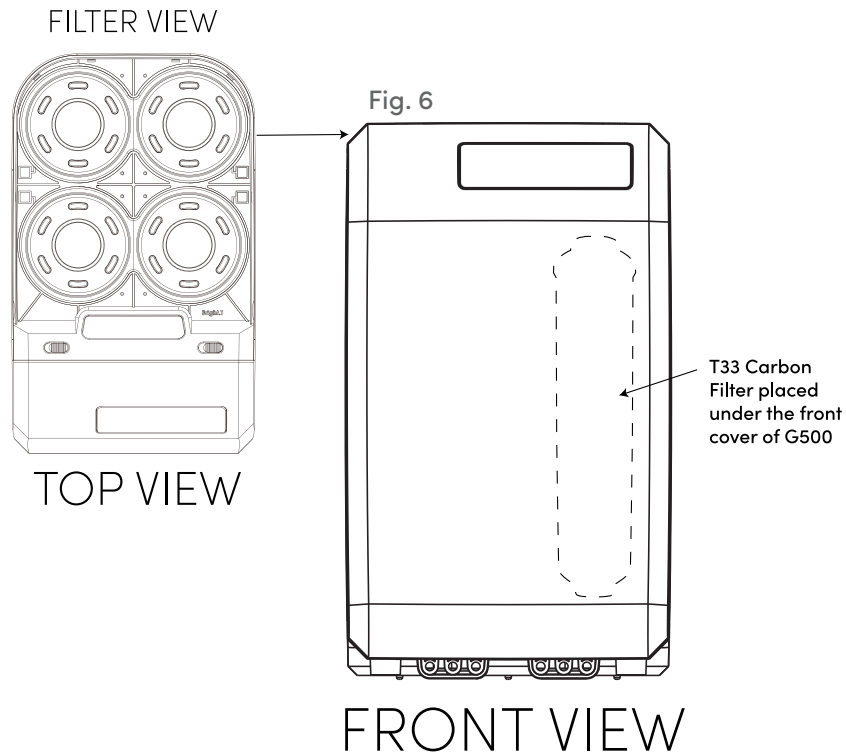

WARRANTY

Global Water Solutions (“GWS”) warrants the product will be free of defects in material and workmanship under normal usage conditions beginning on the date of manufacture and continuing for a warranty coverage period of 1 year.

Warranty applies only when the product is used for its intended purpose and does not apply if a defect is due to improper use of the product, result of accident, misuse, or abuse. If the product was improperly installed or altered in any way, not specifically authorized in writing by the factory, the warranty is void.

The warranty set forth in this paragraph is made expressly in lieu of all other warranties expressed, or implied, including but not limited to merchantability or fitness for a particular purpose.

In no event shall GWS be liable for cost of processing, lost profits, goodwill or any other consequential or incidental damage of any kind resulting from the order or use of the product whether arriving from breach of warranty, nonconformity to ordered specifications, delay in delivery, or any loss sustained by the buyer nor will GWS be liable for labor and expenses necessary to remove and reinstall replacement product.

To obtain service under this warranty, the consumer must deliver alleged defective product, freight prepaid, to an authorized GWS distributor or OEM partner. GWS will either issue credit or at its option, repair or replace defective product freight prepaid to the distributor. GWS reserves the right to make changes in construction, which, in its judgment, constitutes a product improvement. All warranty is subject to verifiable proper installation, operation and maintenance as recommended in this installation manual.



Have questions or need assistance?

www.globalwatersolutions.com